

Quick Consumer Manual



Welcome

Thank you for purchasing a Speed Queen® appliance. We value you as a customer.

At Speed Queen, leading performance is our daily reality. We seek to deliver an outstanding experience in every aspect of laundry. Your machine was built to last 25 years in your home and Speed Queen support has been built to provide you with the best service in the industry.

Installation

Parts included:

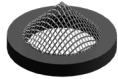

Two (2) filter
screen washers



Two (2) plain
rubber washers

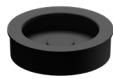

Four (4) rubber
feet



Beaded strap



Two (2) plugs



Two (2)
fill hoses

1. Move unit to area within 4 ft (1.2 m) of final installation.
2. Remove shipping materials.
 - Remove lower panel (2 screws)
 - Remove four (4) bolts securing shipping brace. Remove brace and blue label
 - Remove two (2) bolts from rear of washer
 - Insert two (2) plugs into rear bolt holes
 - Reinstall panel
3. Connect fill hoses – water pressure = 20-120 psi [138-827 kPa].
 - Flush water supply lines
 - Use two filter screen washers with screen facing faucet
 - Use two rubber washers in end of hose connecting to the machine
4. Connect drain hose to drain receptacle – 36 in. [91 cm] recommended height.
 - Use beaded strap to secure drain hose to drain receptacle
5. Position and level the unit.
 - Place four (4) rubber feet on leveling legs
 - Unit must not rock
6. Wipe out inside of washtub.
7. Connect washer to electrical power – on individual branch circuit. Refer to serial plate for electrical ratings.
8. Run washer through one complete cycle to make sure it is operating properly.
9. Check for leaks.

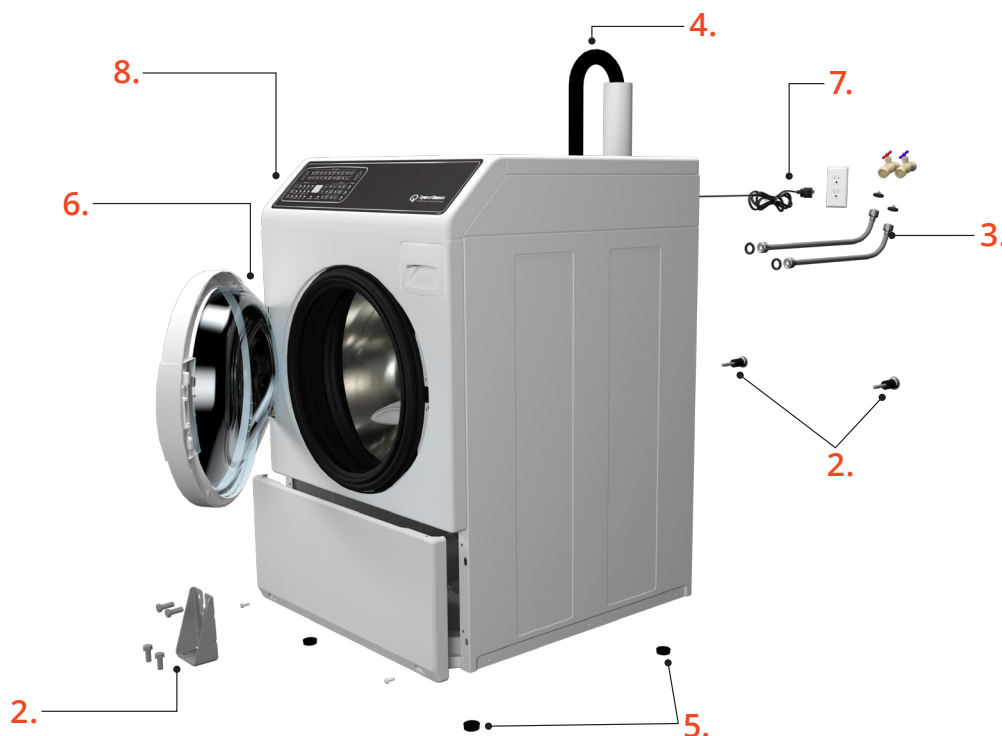

Operating

1. Prepare laundry
2. Add high efficiency (he) laundry supplies*
3. Load laundry
10.5 Kg maximum loading capacity
4. Close door



*Note: Pods must be placed in washtub with laundry.

5. Set cycle
6. Set temperature
7. Set spin speed
(Electronic control only)
8. Set soil level
(Electronic control only)
9. Press start/pause

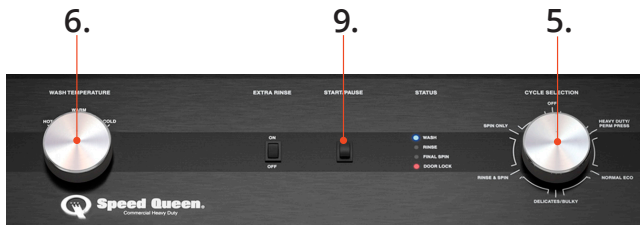

FR5 control

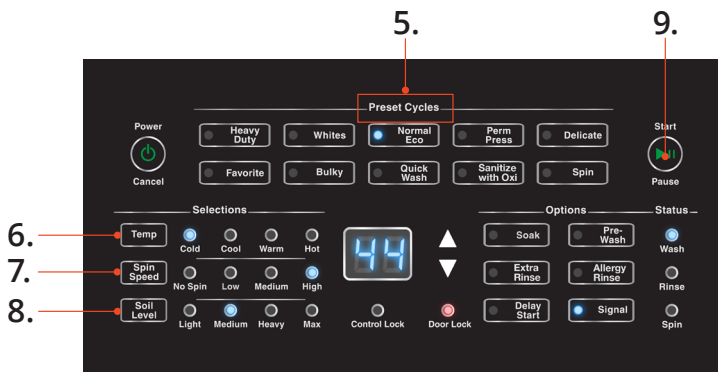

FF7 control

Download full documentation and view installation and operating videos for an immersive experience at Speedqueendoc.net or scan the QR code below.

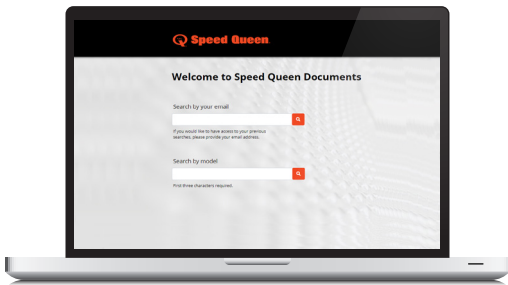

If you wish to receive printed documents at no cost, please complete the order form and return by mail to the address below, or email your request to technicalcommunications@alliancels.com.

Alliance Laundry Systems
Technical Communications
Shepard Street
P.O. Box 990
Ripon, WI 54971
United States



✂ — — — — —

Order Form for
Printed Documentation

Model No. _____

Serial No. _____

Name _____

Address _____

Phone No. _____

Email Address _____

Part No. 807602
May 2019
© Published by permission of the copyright owner –
DO NOT COPY or TRANSMIT
Speed Queen by Alliance Laundry Systems

消費者快速閱讀 手冊



歡迎

感謝您購買SpeedQueen®設備。我們重視客戶價值。在Speed Queen，我們確保機器具有卓越的日常性能，並致力於在洗衣的各個方面提供最佳體驗。您的機器可供您在家中使用25年，且Speed Queen支援服務可為您提供業內最好的服務。

安裝

內含部件：

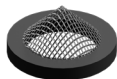

兩(2)個過濾網墊圈



兩(2)個普通橡皮墊圈



四(4)個橡膠腳套



串珠帶



兩(2)個插塞



兩(2)根進水管

1. 將裝置移動到最終安裝位置4英尺（1.2米）範圍內。
2. 拆除運輸材料。
 - 拆除底部面板（兩顆螺絲）。
 - 拆除固定運輸支架的四(4)顆螺栓。拆除支架並清除藍色標籤
 - 拆除洗衣機背面的兩(2)顆螺栓。
 - 將兩(2)個插塞插入背面的螺栓孔中。
 - 重新安裝面板。
3. 連接注水軟管 — 水壓 = 20-120 psi [138-827 kPa]。
 - 沖洗供水管
 - 使用兩個過濾網墊圈，過濾網朝向水龍頭。
 - 在連接到機器的軟管端部使用兩個橡膠墊圈
4. 將排水軟管與排水容器相連 — 建議高度為36英寸[91公分]。
 - 使用串珠帶將排水軟管固定到排水容器上
5. 將機器放平。
 - 將四(4)個橡膠腳套放在調平腳上
 - 不得搖晃設備
6. 擦淨洗衣桶內部。
7. 為洗衣機接通電源 — 與單獨的分支電路相連。參見序號銘牌，瞭解額定電功率。
8. 使洗衣機運行一個完整的週期，以確保其運行正常。
9. 檢查洩漏情況。

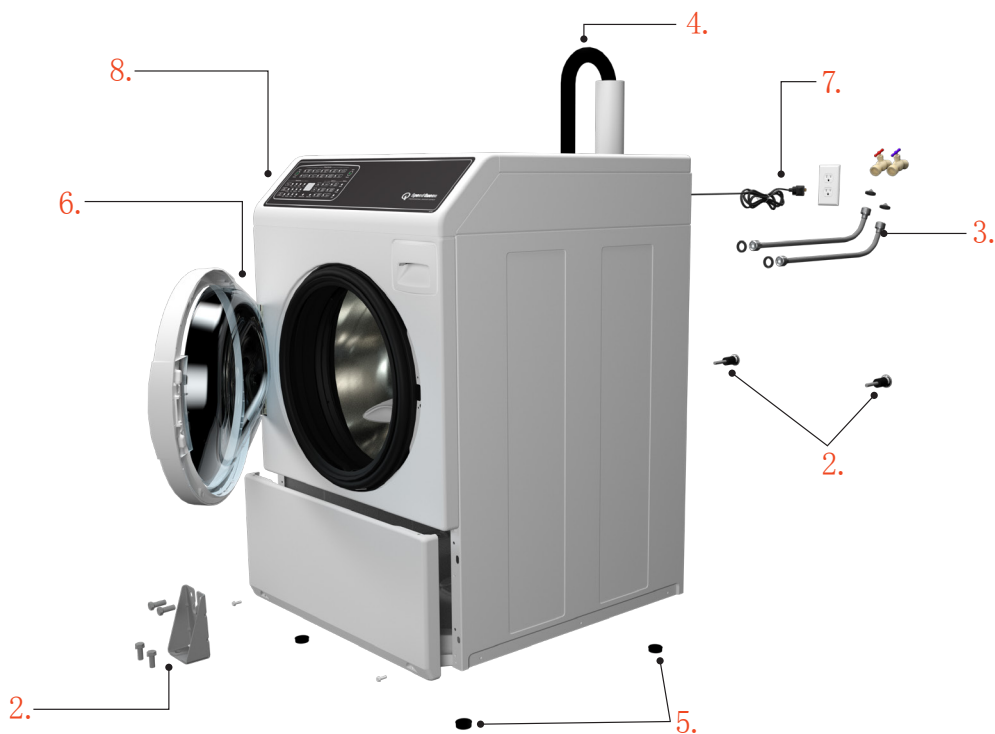

操作

1. 準備洗滌



2. 添加高效洗滌劑
洗滌織物*



3. 填入衣物
不得超過10.5公斤
最大裝載量



4. 關閉機門



*注意：洗衣丸必須與衣物一同投入洗衣筒內。

5. 設置週期

6. 設置水溫

7. 設置脫水速度
(僅限電子控制機型)

8. 設置污漬程度
(僅限電子控制機型)

9. 按下Start/Pause
(啟動/暫停) 按鈕

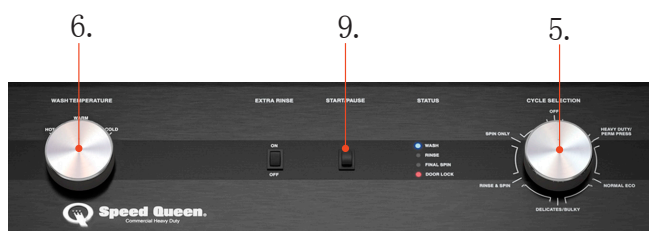

FR5控制

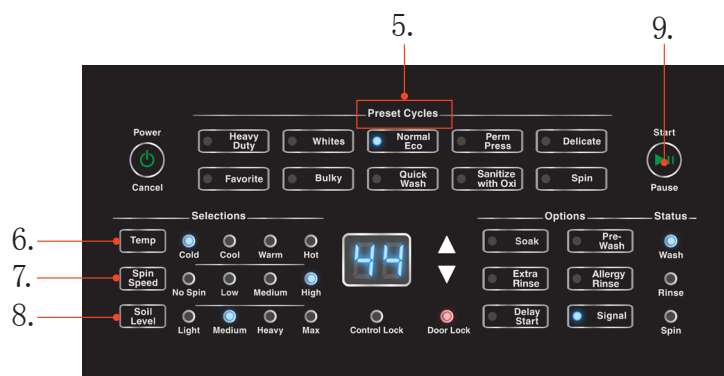

FF7控制

通過登錄speedqueendoc.net或掃描下面的二維碼以下載完整文檔並查看安裝和操作視頻，獲得沉浸式體驗。

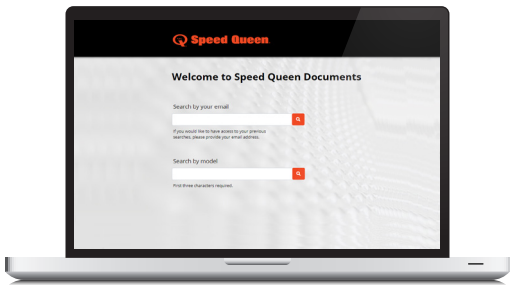

如果您希望免費獲得列印的文檔，請填寫訂單並通過郵件返回以下地址，或發送電子郵件至technicalcommunications@alliances.com。

Alliance Laundry Systems
Technical Communications
Shepard Street
P.O. Box 990
Ripon, WI 54971
United States



✂ - - - - -

列印文檔
的訂單

型號 _____

序號 _____

名稱 _____

地址 _____

電話 _____

电子邮箱地址 _____

文檔編號: 807602
2019年5月
© 經版權所有者許可發佈 -
請勿複製或傳輸
Speed Queen, Alliance Laundry Systems